

Illuminated button operators



8 LP2T BL104



8 LP2T BL204

Push-push button operators



8 LP2T QL104



8 LP2T QL204

Illuminated mushroom head button operators



8 LP2T BL6144



8 LP2T BL6245

Color	Catalog number	Price \$ each
Flush (with side visibility), momentary (complete with mounting adapter).		
Green	8 LP2T BL103	11.00
Red	8 LP2T BL104	11.00
Yellow	8 LP2T BL105	11.00
Blue	8 LP2T BL106	11.00
Transparent	8 LP2T BL107	11.00
Extended (complete with mounting adapter), momentary.		
Green	8 LP2T BL203	12.00
Red	8 LP2T BL204	12.00
Yellow	8 LP2T BL205	12.00
Blue	8 LP2T BL206	12.00
Transparent	8 LP2T BL207	12.00

Color	Catalog number	Price \$ each
Flush (complete with mounting adapter). Maintained, push to release.		
Green	8 LP2T QL103Ⓢ	32.50
Red	8 LP2T QL104Ⓢ	32.50
Yellow	8 LP2T QL105Ⓢ	32.50
Blue	8 LP2T QL106Ⓢ	32.50
Transparent	8 LP2T QL107Ⓢ	32.50
Extended (complete with mounting adapter). Maintained, push to release.		
Green	8 LP2T QL203Ⓢ	38.50
Red	8 LP2T QL204Ⓢ	38.50
Yellow	8 LP2T QL205Ⓢ	38.50
Blue	8 LP2T QL206Ⓢ	38.50
White	8 LP2T QL207Ⓢ	38.50

Ⓢ Use the early-make type, LM2T C10A only.
No normally open contact element, LM2T C10, must be used with this type of button operators.
A maximum of 2 contact elements can be mounted only.

Color	Catalog number	Price \$ each
Momentary. Ø 40mm (1.6in) (complete with mounting adapter)Ⓢ.		
Green	8 LP2T BL6143	18.00
Red	8 LP2T BL6144	18.00
Yellow	8 LP2T BL6145	18.00
Blue	8 LP2T BL6146	18.00
White	8 LP2T BL6148	18.00
Maintained, pull to release. Ø 40mm (1.6in) (complete with mounting adapter)Ⓢ.		
Green	8 LP2T BL6243	37.50
Red	8 LP2T BL6244	37.50
Yellow	8 LP2T BL6245	37.50
Blue	8 LP2T BL6246	37.50
White	8 LP2T BL6248	37.50

Ⓢ The number of contact elements to be mounted is given in the side notes.

Operational characteristics

- Ambient conditions:
 - Operating temperature: -13...+140°F (-25...+60°C)
 - Storage temperature: -40...+158°F (-40...+70°C)
- Any mounting position is allowed
- Degree of protection: IP65.

Materials

Polyamide and polycarbonate.

Mechanical endurance

Operating force: 1.76lb / 0.8kg (operator).

Mechanical life:

- Push-push operators: 500,000 cycles
- Mushroom head latch operators: 300,000 cycles
- All others: 1,000,000 cycles.

Mounting adapter

Standard supply with the operator.

Operators latch onto the mounting adapter with a simple rotation.

The adapter is fixed to the mounting surface by means of incorporated screws (Tmax = 5.3lbin / 0.6 Nm).

Contact elements for illuminated push-push operators:

See page 7-17.

Catalog number: 8 LM2T C10A (EM)
8 LM2T C01 (1NC)

Contact elements snap onto the mounting adapter.

Up to 2 contacts can be fitted on the mounting adapter in a row, 1 each on the right and left, along with the lamp-holder in the center position, of which LM2T EL400, LM2T ZL230, LM2T L... or LM2T M... (see page 7-18).

With lamp-holder LM2T YL... or LM2T GL..., one auxiliary contact can be mounted only (see page 7-18).

Contact elements for illuminated momentary button and mushroom-head operators:

See page 7-17.

Catalog numbers: 8 LM2T C10 (1NO)
8 LM2T CF10 (1NO Faston)
8 LM2T C10A (EM)
8 LM2T C01 (1NC)
8 LM2T CF01 (1NC Faston)
8 LM2T C01D (LB)

Contact elements snap onto the mounting adapter.

On LP2T BL1, LP2T BL2 or LP2T BL61 operators, the following can be fitted on the mounting adapter:

- Up to 4 contacts, 2 each on the left and right, when one of the following lamp-holders is used: LM2T DL400, LM2T EL400, LM2T VL230, LM2T ZL230, LM2T L or LM2T M (see page 7-18).
- Up to 2 contacts, one on top of the other of the same type only, when one of the following lamp-holders is used: LM2T XL, LM2T YL, LM2T FL or LM2T GL (see page 7-18).

On LP2T BL62... operator, the following can be fitted on the mounting adapter:

- Up to 2 contacts, 1 each on the right and left, when one of the following lamp-holders is used: LM2T DL400, LM2T EL400, LM2T VL230, LM2T ZL230, LM2T L or LM2T M (see page 7-18)
- Up to 2 contacts, one on top of the other of the same type only, when one of the following lamp-holders is used: LM2T XL, LM2T YL, LM2T FL or LM2T GL (see page 7-18).

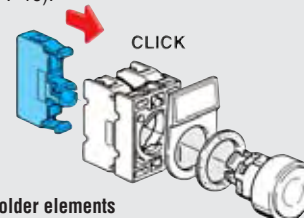

Lamp-holder elements

See pages 7-18.

Bulbs

Maximum recommended power: 1.2W. See page 7-20.

Certifications and compliance

UL listed for USA and Canada, file E93601.

Compliant with standards: IEC/EN 60947-1, IEC/EN 60947-5-1.